

210 Bar Standard Cylinder Mounting : Flange And Side Lug

Head
Rectangular
(ISO ME5)

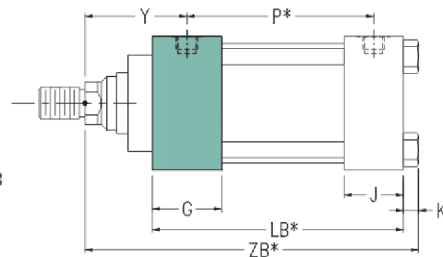

Cap
Rectangular
(ISO ME6)

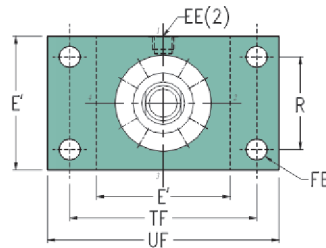
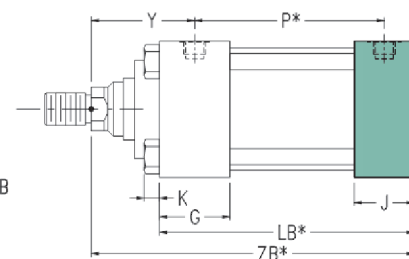
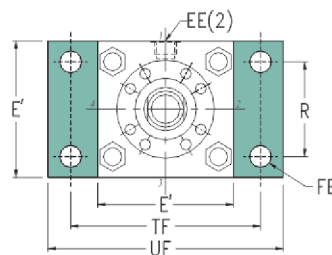

Side Lugs
(ISOMS2)

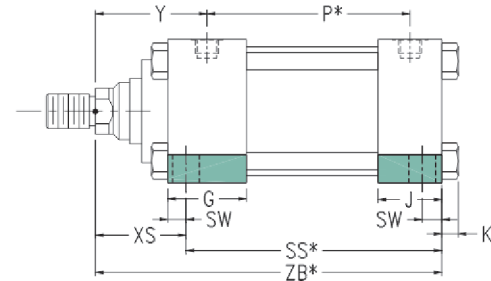
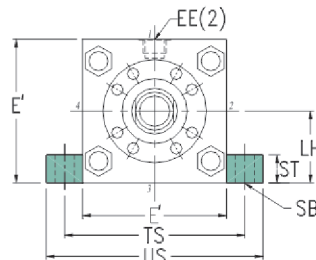

Mounting Dimensions

Bore Dia.	E	EE BSP/G INCHES	FB	G	J	K	LB*	LH	P*	R	SB	SS*	ST	SW	TF	TS	UF	US	XS	Y	ZB*	ZJ*
25	40 ¹	1/4	5.5	40	25	4	89	19 +0.000 -0.084	53	27	6.6	73	8.5	8	51	54	65	72	33	50	118	114
32	45 ¹	1/4	6.6	40	25	5	93	22 +0.000 -0.084	56	33	9	73	12.5	10	58	63	70	84	45	60	133	128
40	63	3/8	11	45	38	6.5	118	31 +0.000 -0.100	73	41	11	98	12.5	10	87	83	110	103	45	62	159.5	153
50	75	1/2	14	45	38	10	118	37 +0.000 -0.100	74	52	14	92	19	13	105	102	130	127	54	67	169	159
63	90	1/2	14	45	38	10	120	44 +0.000 -0.100	80	65	18	86	26	17	117	124	145	161	65	71	178	168
80	115	3/4	18	50	45	13	139	57 +0.000 -0.120	93	83	18	105	26	17	149	149	180	186	68	77	203	190
100	130	3/4	18	50	45	13	146	63 +0.000 -0.120	101	97	26	102	32	22	162	172	200	216	79	82	216	203
125	165	1	22	58	58	18	175	82 +0.000 -0.140	117	126	26	131	32	22	208	210	250	254	79	86	250	232
160	205	1	26	58	58	22	188	101 +0.000 -0.140	130	155	33	130	38	29	253	260	300	318	86	86	267	245
200	245	1 1/4	33	76	76	24	242	122 +0.000 -0.160	165	190	39	172	44	35	300	311	360	381	92	98	323	299

All dimensions in millimetres unless otherwise stated.

* Add stroke to all starred dimensions.

¹ Head depth increased by 5mm to accommodate port on 25mm and 32mm bore cylinders.